

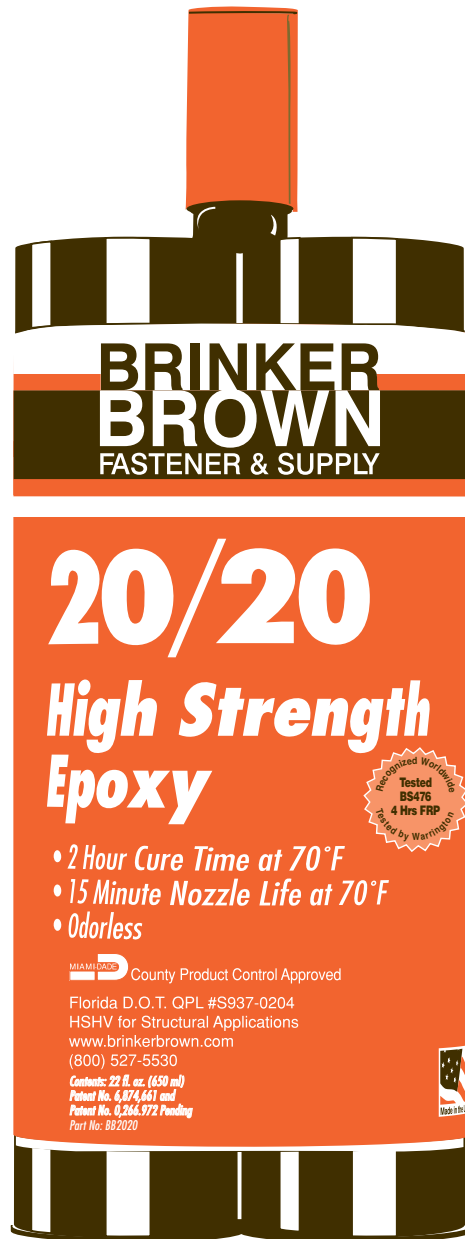

www.brinkerbrown.com

Submittal Information



12290 Crystal Commerce Loop • Fort Myers, FL 33966
Phone: 239-939-3535 • Fax: 239-939-1691 • Toll Free: 800-527-5530

369 Industrial Blvd. • Naples, FL 34104
Phone: 239-643-3500 • Fax: 239-643-6554 • Toll Free: 800-527-5530

www.brinkerbrown.com

Brinker Brown Adhesive



**High Strength Epoxy
tested in accordance
to ICC-ES AC308**

The epoxy resin and hardener are completely mixed as they are dispensed from the dual cartridge through a static mixing nozzle, directly into the anchor hole. Brinker Brown can be used with threaded rod or rebar.

Compliant with 2003 IBC & 2006 IBC. Category 1 performance rating. One bond strength — no load reduction factors (ϕ) required for installation conditions such as dry, water-saturated, water-filled, underwater, and submerged applications.



ADVANTAGES

FORMULATED FOR HOT OR WARM WEATHER

- Fire rated: tested up to 4hrs FRP
- High strength Epoxy
- 15 minute nozzle life at 70° degrees F.



**International
Standard
Fire Resistance
Performance**

NON-OFFENSIVE ODOR

- Virtually odorless, can be used indoors

Curing Times

BASE MATERIAL TEMPERATURE	WORKING TIME	INITIAL * CURE TIME	FULL CURE TIME
20°C 70°F	15 minutes	2 hours	24 hours

* Time required to achieve 25% ultimate load.

INSTALLATION STEPS

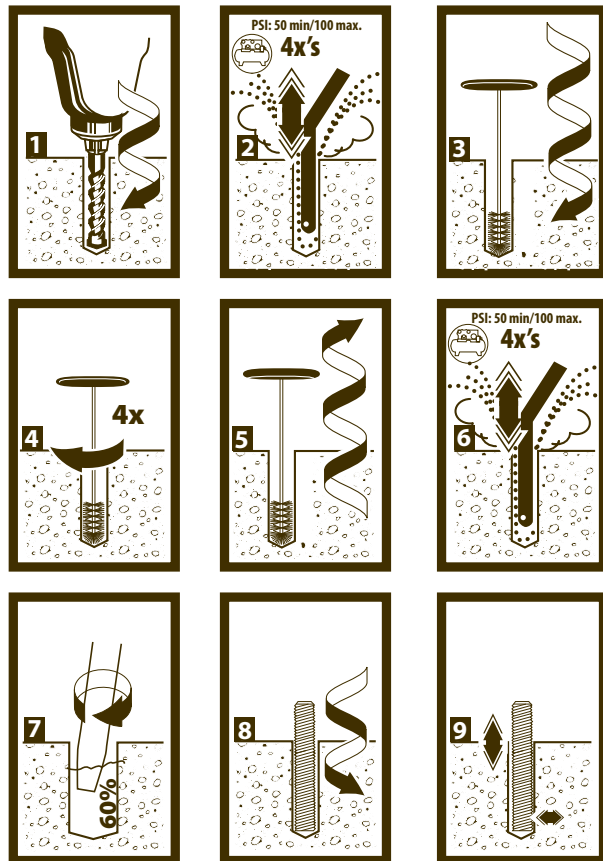



*For ICC-ES cleaning method, please go online to www.icc-es.org or www.itwredhead.com.

APPROVALS/LISTINGS

ASTM C881-02, except for gel time and tensile strength
 ICC Evaluation Service, Inc.— No. ESR 1137
 DOT Approvals
 Miami-Dade County # 04-0405.01
 Florida Building Code Approved
 Patent No. 6,874,661
 Patent No. 0,266,972 Pending

22 oz. Ordering Information

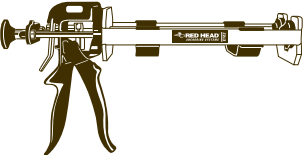
	DESCRIPTION	BOX/BAG QTY	CARTON QTY
	Brinker Brown 20/20 Adhesive, 22 Fluid Oz. Cartridge	1	12
	Mixing Nozzle for 22 oz. Cartridge Nozzle diameter fits 3/8" to 5/8" holes (overall length of nozzle 14")	24	N/A
	Hand Dispenser for 22 oz. Cartridges	1	6

ESTIMATING TABLE

BRINKER BROWN 20/20
22 Fluid Ounce Cartridge

Number of Anchoring Installations Per Cartridge* Using Reinforcing Bar with Brinker Brown Adhesive in Concrete

REBAR	DRILL HOLE DIA. INCHES	EMBEDMENT DEPTH IN INCHES (mm)														
		1 (25.4)	2 (50.8)	3 (76.2)	4 (101.6)	5 (127.0)	6 (152.4)	7 (177.8)	8 (203.2)	9 (228.6)	10 (254.0)	11 (279.4)	12 (304.8)	13 (330.2)	14 (355.6)	15 (381.0)
# 3	1/2	388.9	194.5	129.6	97.2	77.8	64.8	55.6	48.6	43.2	38.9	35.4	32.4	29.9	27.8	25.9
# 4	5/8	293.8	146.9	97.9	73.5	58.5	49.0	42.0	36.7	32.6	29.4	26.7	24.5	22.6	21.0	19.6
# 5	3/4	225.4	112.7	75.1	56.3	45.1	37.6	32.2	28.2	25.0	22.5	20.5	18.8	17.3	16.1	15.0
# 6	7/8	182.0	91.0	60.7	45.5	36.4	30.3	26.0	22.7	20.2	18.2	16.5	15.2	14.0	13.0	12.1
# 7	1-1/8	87.2	43.6	29.1	21.8	17.4	14.5	12.5	10.9	9.7	8.7	7.9	7.3	6.7	6.2	5.8
# 8	1-1/4	77.6	38.8	25.9	19.4	15.5	12.9	11.1	9.7	8.6	7.8	7.1	6.5	6.0	5.5	5.2
# 9	1-3/8	81.0	40.5	27.0	20.2	16.2	13.5	11.6	10.1	9.0	8.1	7.4	6.7	6.2	5.8	5.4
# 10	1-1/2	66.2	33.1	22.1	16.6	13.2	11.0	9.5	8.3	7.4	6.6	6.0	5.5	5.1	4.7	4.4
# 11	1-3/4	40.5	20.2	13.5	10.1	8.1	6.7	5.8	5.1	4.5	4.0	3.7	3.4	3.1	2.9	2.7

* The number of anchoring installations is based upon calculations of hole volumes using ANSI tolerance carbide tipped drill bits, the nominal areas of the reinforcing bars and the stress areas of the threaded rods. These estimates do not account for waste.
* Oversized holes acceptable but volume of adhesive will increase.

ESTIMATING TABLE

CLAMPING FORCE PROVIDED ON PAGE 3

BRINKER BROWN 20/20
22 Fluid Ounce Cartridge

Number of Anchoring Installations Per Cartridge* Using Threaded Rod with Brinker Brown Adhesive in Concrete

ROD In. (mm)	DRILL HOLE DIA. INCHES	EMBEDMENT DEPTH IN INCHES (mm)														
		1 (25.4)	2 (50.8)	3 (76.2)	4 (101.6)	5 (127.0)	6 (152.4)	7 (177.8)	8 (203.2)	9 (228.6)	10 (254.0)	11 (279.4)	12 (304.8)	13 (330.2)	14 (355.6)	15 (381.0)
1/4 (6.4)	5/16	721.2	360.6	240.4	180.3	144.2	120.2	103.0	90.2	80.1	72.1	65.6	60.1	55.5	51.5	48.1
3/8 (9.5)	7/16	417.6	208.8	139.2	104.4	83.5	69.6	59.7	52.2	46.4	41.8	38.0	34.8	32.1	29.8	27.8
1/2 (12.7)	9/16	300.5	150.3	100.2	75.1	60.1	50.1	42.9	37.6	33.4	30.1	27.3	25.0	23.1	21.5	20.0
5/8 (15.9)	3/4	153.8	76.9	51.3	38.4	30.8	25.6	22.0	19.2	17.1	15.4	14.0	12.8	11.8	11.0	10.3
3/4 (19.1)	7/8	121.7	60.8	40.6	30.4	24.3	20.3	17.4	15.2	13.5	12.2	11.1	10.1	9.4	8.7	8.1
7/8 (22.2)	1	100.9	50.5	33.6	25.2	20.2	16.8	14.4	12.6	11.2	10.1	9.2	8.4	7.8	7.2	6.7
1 (25.4)	1-1/8	83.0	41.5	27.7	20.7	16.6	13.8	11.9	10.4	9.2	8.3	7.5	6.9	6.4	5.9	5.5
1-1/4 (31.8)	1-3/8	62.8	31.4	20.9	15.7	12.6	10.5	9.0	7.8	7.0	6.3	5.7	5.2	4.8	4.5	4.2

* The number of anchoring installations is based upon calculations of hole volumes using ANSI tolerance carbide tipped drill bits, the nominal areas of the reinforcing bars and the stress areas of the threaded rods. These estimates do not account for waste.
* Oversized holes acceptable but volume of adhesive will increase.

PACKAGING

1. Disposable, self-contained 22 ounce cartridge system capable of dispensing both epoxy components in the proper mixing ratio
2. Epoxy components dispensed through a static mixing nozzle that thoroughly mixes the material and places the epoxy at the base of the pre-drilled hole
3. Cartridge markings: Include manufacturer's name, batch number and best-used-by date, mix ratio by volume, ANSI hazard classification, and appropriate ANSI handling precautions

SUGGESTED SPECIFICATIONS

EPOXY ADHESIVE:

1. Two component, 100% solids (containing no solvents), non-sag paste, insensitive to moisture, grey in color
2. Water solubility: None
3. Meets ASTM C881-02, except for gel time and tensile strength.
4. Compressive Strength, ASTM D695: 10,344 psi minimum
5. Heat Deflection Temperature; 144°F minimum
6. Shelf life: Best if used within 18 months

PERFORMANCE TABLE

DRILL HOLE DIAMETERS
PROVIDED ON PAGE 2

BRINKER BROWN 20/20 Epoxy Adhesive

Average Ultimate Tension and Shear Loads^{1,2,3} for Threaded Rod Installed in Solid Concrete

THREADED ROD DIA. In. (mm)	MAX. CLAMPING FORCE AFTER PROPER CURE Ft.-Lbs. (Nm)	EMBEDMENT CONCRETE In. (mm)	2000 PSI (13.8 MPa) CONCRETE		4000 PSI (27.6 MPa) CONCRETE	
			ULTIMATE TENSION Lbs. (kN)	ULTIMATE SHEAR Lbs. (kN)	ULTIMATE TENSION Lbs. (kN)	ULTIMATE SHEAR Lbs. (kN)
3/8 (9.5)	9 (12.2)	3-3/8 (85.7)	5,060 (22.5)	6,227 (27.7)	8,396 (37.3)	6,227 (27.7)
		4-1/2 (114.3)	6,465 (28.8)	6,227 (27.7)	10,490 (46.7)	6,227 (27.7)
1/2 (12.7)	16 (21.6)	4-1/2 (114.3)	10,484 (46.6)	12,016 (53.5)	13,476 (59.9)	12,016 (53.5)
		6 (152.4)	12,392 (55.1)	12,016 (53.5)	19,166 (85.3)	12,016 (53.5)
		7-1/2 (190.5)	-- --	12,016 (53.5)	20,572 (91.5)	12,016 (53.5)
5/8 (15.9)	47 (63.5)	5-5/8 (142.9)	14,634 (65.1)	17,547 (78.1)	20,880 (92.9)	17,547 (78.1)
		7-1/2 (190.5)	20,182 (89.8)	17,547 (78.1)	27,939 (124.3)	17,547 (78.1)
		9-3/8 (238.1)	-- --	17,547 (78.1)	32,249 (143.5)	17,547 (78.1)
3/4 (19.1)	90 (121.5)	6-3/4 (171.5)	18,966 (84.4)	24,918 (110.8)	29,019 (129.1)	24,918 (110.8)
		9 (228.6)	25,988 (115.6)	24,918 (110.8)	43,812 (194.9)	24,918 (110.8)
		11-1/4 (285.8)	-- --	24,918 (110.8)	47,927 (213.2)	24,918 (110.8)
1 (25.4)	276 (372.6)	9 (228.6)	43,804 (194.9)	43,648 (194.2)	53,531 (238.1)	43,648 (194.2)
		12 (304.8)	45,351 (201.6)	43,648 (194.2)	64,022 (284.8)	43,648 (194.2)
		15 (381.0)	-- --	43,648 (194.2)	82,547 (367.2)	43,648 (194.2)

1 Allowable working loads for the single installations under static loading should not exceed 25% (an industry standard) capacity or the allowable load of the anchor rod.

2 Ultimate load values in 2000 and 4000 psi stone aggregate concrete. Ultimate loads are indicated for the embedment shown in the Embedment in Concrete column. Performance values are based on the use of high strength threaded rod (ASTM A193 Gr. B7). The use of lower strength rods will result in lower ultimate tension and shear loads.

3 Linear interpolation may be used for intermediate spacing and edge distances.

PERFORMANCE TABLE

DRILL HOLE DIAMETERS
PROVIDED ON PAGE 2

**BRINKER BROWN 20/20
Epoxy Adhesive**

**Allowable Tension Loads¹ for Threaded Rod Installed
in Solid Concrete**

THREADED ROD DIA. In. (mm)	MIN. EMBEDMENT DEPTH In. (mm)	ALLOWABLE TENSION LOAD BASED ON EPOXY BOND STRENGTH		ALLOWABLE TENSION LOAD BASED ON STEEL STRENGTH		
		2000 PSI (13.8 MPa) CONCRETE Lbs. (kN)	4000 PSI (27.6 MPa) CONCRETE Lbs. (kN)	ASTM A307 (SAE 1018) Lbs. (kN)	ASTM A193 GR. B7 (SAE 4140) Lbs. (kN)	ASTM F593 AISI 304 SS Lbs. (kN)
3/8 (9.5)	3-3/8 (85.7)	1,265 (5.6)	2,092 (9.3)	2,080 (9.3)	4,340 (19.3)	3,995 (17.8)
	4-1/2 (114.3)	1,616 (7.2)	2,622 (11.7)	2,080 (9.3)	4,340 (19.3)	3,995 (17.8)
1/2 (12.7)	4-1/2 (114.3)	3,004 (13.4)	3,369 (15.0)	3,730 (16.6)	7,780 (34.6)	7,155 (31.8)
	6 (152.4)	3,098 (13.8)	4,791 (21.3)	3,730 (16.6)	7,780 (34.6)	7,155 (31.8)
5/8 (15.9)	5-5/8 (142.9)	3,659 (16.3)	5,220 (23.2)	5,870 (26.1)	12,230 (54.4)	11,250 (50.0)
	7-1/2 (190.5)	5,046 (22.4)	6,985 (31.1)	5,870 (26.1)	12,230 (54.4)	11,250 (50.0)
3/4 (19.1)	6-3/4 (171.5)	4,742 (21.1)	7,255 (32.3)	8,490 (37.8)	17,690 (78.7)	14,860 (66.1)
	9 (228.6)	6,497 (28.9)	10,057 (44.7)	8,490 (37.8)	17,690 (78.7)	14,860 (66.1)
1 (25.4)	9 (228.6)	10,951 (48.7)	11,209 (49.9)	15,180 (67.5)	31,620 (140.6)	26,560 (118.1)
	12 (304.8)	11,338 (50.4)	15,923 (70.8)	15,180 (67.5)	31,620 (140.6)	26,560 (118.1)

1 Use lower value of either bond or steel strength for allowable tensile load.
2 Linear interpolation may be used for intermediate spacing and edge distances.

PERFORMANCE TABLE

DRILL HOLE DIAMETERS
PROVIDED ON PAGE 2

**BRINKER BROWN 20/20
Epoxy Adhesive**

**Allowable Shear Loads^{1,2} for Threaded Rod Installed in
Solid Concrete**

THREADED ROD DIA. In. (mm)	MIN. EMBEDMENT DEPTH In. (mm)	ALLOWABLE SHEAR LOAD BASED ON CONCRETE STRENGTH		ALLOWABLE SHEAR LOAD BASED ON STEEL STRENGTH		
		2000 PSI (13.8 MPa) CONCRETE Lbs. (kN)	4000 PSI (27.6 MPa) CONCRETE Lbs. (kN)	ASTM A307 (SAE 1018) Lbs. (kN)	ASTM A193 GR. B7 (SAE 4140) Lbs. (kN)	ASTM F593 AISI 304 SS Lbs. (kN)
3/8 (9.5)	3-3/8 (85.7)	1,557 (6.9)	1,557 (6.9)	1,040 (4.6)	2,170 (9.7)	1,995 (8.9)
1/2 (12.7)	4-1/2 (114.3)	3,004 (13.4)	3,004 (13.4)	1,870 (8.3)	3,895 (17.3)	3,585 (15.9)
5/8 (15.9)	5-5/8 (142.9)	4,387 (19.5)	4,387 (19.5)	2,940 (13.1)	6,125 (27.2)	5,635 (25.1)
3/4 (19.1)	6-3/4 (171.5)	6,230 (27.7)	6,230 (27.7)	4,250 (18.9)	8,855 (39.4)	7,440 (33.1)
1 (25.4)	9 (228.6)	10,912 (48.5)	10,912 (48.5)	7,590 (33.8)	15,810 (70.3)	13,285 (59.1)

1 Use lower value of either concrete or steel strength for allowable shear load.
2 Linear interpolation may be used for intermediate spacing and edge distances.

Combined Shear and Tension Loading—for Brinker Brown Adhesive Anchors

Allowable loads for anchors under tension and shear loading at the same time (combined loading) will be lower than the allowable loads for anchors subjected to 100% tension or 100% shear. Use the following equation to evaluate anchors in combined loading conditions:

$$\left(\frac{N_a}{N_s}\right) + \left(\frac{V_a}{V_s}\right) \leq 1$$

N_a = Applied Service Tension Load

V_a = Applied Service Shear Load

N_s = Allowable Tension Load

V_s = Allowable Shear Load

PERFORMANCE TABLE

DRILL HOLE DIAMETERS
PROVIDED ON PAGE 2

**BRINKER BROWN 20/20
Epoxy Adhesive**

**Average Ultimate Tension Loads^{1,2,3} for Reinforcing Bar
Installed in Solid Concrete**

REINFORCING BAR In. (mm)	EMBEDMENT IN CONCRETE In. (mm)	2000 PSI (13.8 MPa) IN CONCRETE ULTIMATE TENSION Lbs. (kN)	4000 PSI (27.6 MPa) IN CONCRETE ULTIMATE TENSION Lbs. (kN)	ULTIMATE TENSILE AND YIELD STRENGTH GRADE 60 REBAR	
				MINIMUM YIELD STRENGTH Lbs. (kN)	MINIMUM ULTIMATE TENSILE STRENGTH Lbs. (kN)
# 3 (9.5)	3-3/8 (85.7)	7,480 (33.3)	8,090 (35.9)	6,600 (29.4)	9,900 (44.0)
	4-1/2 (114.3)	-- --	10,488 (46.6)	6,600 (29.4)	9,900 (44.0)
# 4 (12.7)	4-1/2 (114.3)	-- --	14,471 (64.4)	12,000 (53.4)	18,000 (80.1)
	6 (152.4)	11,235 (50.0)	20,396 (90.7)	12,000 (53.4)	18,000 (80.1)
# 5 (15.9)	5-5/8 (142.9)	-- --	21,273 (94.6)	18,600 (82.7)	27,900 (124.1)
	7-1/2 (190.5)	18,108 (80.6)	31,863 (141.7)	18,600 (82.7)	27,900 (124.1)
# 6 (19.1)	6-3/4 (171.5)	-- --	27,677 (123.1)	26,400 (117.4)	39,600 (176.2)
	9 (228.6)	29,338 (130.5)	47,879 (212.9)	26,400 (117.4)	39,600 (176.2)
# 7 (22.2)	7-7/8 (200.0)	-- --	43,905 (195.3)	36,000 (160.1)	54,000 (240.2)
	10-1/2 (266.7)	-- --	52,046 (231.5)	36,000 (160.1)	54,000 (240.2)
# 8 (25.4)	9 (228.6)	-- --	55,676 (247.7)	47,400 (210.9)	71,100 (316.3)
	12 (304.8)	48,000 (213.5)	77,358 (344.1)	47,400 (210.9)	71,100 (316.3)
# 9 (28.6)	10-1/8 (257.2)	-- --	62,443 (277.8)	60,000 (266.9)	90,000 (400.4)
	13-1/2 (342.9)	-- --	71,959 (320.1)	60,000 (266.9)	90,000 (400.4)
# 10 (31.8)	11-1/4 (285.8)	-- --	70,165 (312.1)	76,200 (339.0)	114,300 (508.5)
	15 (381.0)	-- --	78,545 (349.4)	76,200 (339.0)	114,300 (508.5)

- 1 Allowable working loads for the single installations under static loading should not exceed 25% ultimate capacity or the allowable load of the anchor rod.
- 2 Ultimate load values in 2000 and 4000 psi stone aggregate concrete. Ultimate loads are indicated for the embedment shown in the Embedment in Concrete column. Performance values are based on the use of minimum Grade 60 reinforcing bar. The use of lower strength rods will result in lower ultimate tension and shear loads.
- 3 SHEAR DATA: Provided the distance from the rebar to the edge of the concrete member exceeds 1.25 times the embedment depth of the rebar, calculate the ultimate shear load for the rebar anchorage as 60% of the ultimate tensile strength of the rebar.

**Brinker Brown Adhesive Anchoring System
Spacing/Edge Distance Load Factor Summary^{1,2}**

LOAD FACTOR	DISTANCE FROM EDGE OF CONCRETE
Critical Edge Distance—Tension	
100% Tension Load	1.25 x Anchor Embedment
Minimum Edge Distance—Tension	
70% Tension Load	0.50 x Anchor Embedment
Critical Edge Distance—Shear	
100% Shear Load	1.25 x Anchor Embedment
Minimum Edge Distance—Shear	
30% Shear Load	0.30 x Anchor Embedment
LOAD FACTOR	DISTANCE FROM ANOTHER ANCHOR
Critical Spacing—Tension	
100% Tension Load	1.50 x Anchor Embedment
Minimum Spacing—Tension	
75% Tension Load	0.75 x Anchor Embedment
Critical Spacing—Shear	
100% Shear Load	1.50 x Anchor Embedment
Minimum Spacing—Shear	
30% Shear Load	0.50 x Anchor Embedment

- 1 Use linear interpolation for load factors at edge distances or spacing distances between critical and minimum.
- 2 Anchors are affected by multiple combination of spacing and/or edge distance loading and direction of the loading. Use the product of tension and shear loading factors in design.

Brinker Brown Chemical Resistance

**BRINKER BROWN 20/20
Chemical Resistance**

	HIGH Anchors installed with Brinker Brown Epoxy Adhesive could be submerged in these materials.	MEDIUM Intermittent exposure or temporary submersion due to splash or spill.	LOW Exposure of Brinker Brown Epoxy Adhesive should be limited to splash and spill exposure followed by immediate cleanup.
Xylene	✓		
Gasoline	✓		
20% Caustic (NaOH)	✓		
Fresh Water	✓		
Salt Water	✓		
10% Sulfuric Acid (H ₂ SO ₄)		✓	
3.5% Hydrochloric Acid (HCL)		✓	
9% Phosphoric Acid		✓	
Toluene		✓	
10% Nitric Acid		✓	
8.5% Ammonium Hydroxide		✓	
5% Bleach			✓
Acetone			✓
Glacial Acetic Acid			✓
Methanol			✓
Methylene Chloride			✓

Important Note: This chemical resistance table above only applies when Brinker Brown epoxy is used for installing anchors into concrete in a conventional manner with recommended hole sizes. Installation of the anchor must always be done in a drilled hole which is completely cleaned of all concrete dust and is dry. Exposure to solvents, chemical and water, as listed above, should occur only after the Brinker Brown epoxy has full cured.

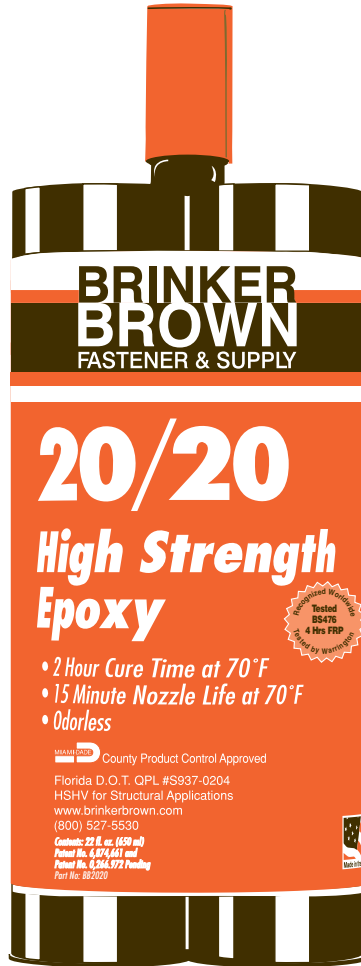

**BRINKER
BROWN**
FASTENER & SUPPLY
www.brinkerbrown.com

12290 Crystal Commerce Loop • Fort Myers, FL 33966
Phone: 239-939-3535 • Fax: 239-939-1691 • Toll Free: 800-527-5530

369 Industrial Blvd. • Naples, FL 34104
Phone: 239-643-3500 • Fax: 239-643-6554 • Toll Free: 800-527-5530